

CAMDEN MIDDLE SCHOOL HANDBOOK 2014-2015
TABLE OF CONTENTS

DAILY SCHEDULES.....	2
CMS P.A.W.S. EXPECTATIONS	2
MISSION STATEMENT/BELIEFS.....	2
PARENTAL RESPONSIBILITIES	3
LEAVING SCHOOL DURING SCHOOL HOURS.....	3
STUDENTS STAYING ON GROUNDS AFTER SCHOOL HOURS	3
SCHOOL ACTIVITIES/CLUBS	3
INTERSCHOLASTIC ATHLETICS	4
PROMOTION STANDARDS.....	4
STUDENT DROP OFF AND PICK UP.....	5
DRESS CODE	5
ITEMS NOT ALLOWED AT SCHOOL.....	6
CAFETERIA BEHAVIOR.....	6
POLICIES NEW OR UPDATED DURING THE PAST FISCAL YEAR	7
CAMDEN COUNTY SCHOOL CALENDAR 2014-2015.....	7
EMERGENCY CONTACT	7
VISITORS	8
BREAKFAST AND LUNCH - https://www.mynutrikids.com/Login.aspx	8
FOOD ALLOWED TO BE BROUGHT ON CAMPUS.....	8
PLEDGE OF ALLEGIANCE /MOMENT OF REFLECTION - Policy IKD.....	8
PARENT/SCHOOL COMMUNICATION	8
DIRECTORY INFORMATION	8
USE OF STUDENT PHOTOGRAPHS/VIDEO FOOTAGE	8
CHILD STUDY TEAM	8
GUIDANCE SERVICES.....	8
SOCIAL WORK SERVICES	9
SURVEYS.....	9
TITLE I - NO CHILD LEFT BEHIND and TITLE I PARENTAL INVOLVEMENT POLICY	9
FAMILY EDUCATIONAL RIGHTS AND PRIVACY ACT (FERPA).....	9
ADMINISTRATION OF MEDICINES	9
COMMUNICABLE DISEASE – Policy JGCCA	9
ACCIDENTS AND INSURANCE	9
BICYCLE SAFETY - O.C.G.A. 40-6-296	10
FIRE DRILLS - Policy EBBC-R.....	10
EMERGENCY CLOSINGS - Policy AFC and Policy AFC-R.....	10
PARENT PROTOCOL DURING SCHOOL CRISIS.....	10
SECLUSION/RESTRAINT – Policy JGF(2).....	10
VIDEO SURVEILLANCE – Policy JG(1).....	10
ASBESTOS PLAN.....	10
ABSENSES/EXCUSES.....	9
MAKE UP WORK WHEN ABSENT - Policy JBD	10
HOSPITAL/HOMEBOUND PROGRAM – Policy JBD.....	11
TARDIES – DISMISSALS.....	11
PROGRESS REPORTS & REPORT CARDS	11
HONOR ROLLS – Policy IHD	11
GIFTED	10
INTERNET USAGE BY STUDENTS - Policy IFBG and Policy IFBG-R	11
SEX EDUCATION AND AIDS PREVENTION INSTRUCTION WAIVER.....	11
TEXTBOOKS	11
TRANSFER AND WITHDRAWAL	11
SCHOOL FUNDRAISING ACTIVITIES.....	11
NOTICE REGARDING TEACHER/PARAPROFESSIONAL QUALIFICATIONS	11
EQUAL EDUCATION OPPORTUNITIES - Policy JAA	12
DRESS CODE	12
ITEMS NOT ALLOWED AT SCHOOL.....	12
STUDENT REPORTING OF ACTS OF SEXUAL ABUSE OR SEXUAL MISCONDUCT	12
PROGRESSIVE DISCIPLINE PROCESS	12
SCHOOL GUIDELINES FOR STUDENT BEHAVIOR	12
STUDENT BEHAVIOR CODE - Policy JCDA-R.....	12
STUDENT BEHAVIOR CODE AND CONSEQUENCES.....	13
BUS CONDUCT	18
BUS PASS PROCEDURE.....	18
SCHOOL BUS SAFETY REMINDER.....	18
INTERNET AGREEMENTS	18

ATTENDANCE - [Policy JB](#)
 ENTRANCE AGE - [Policy JBB](#)
 IMMUNIZATIONS - [Policy JGCB](#)
 TESTING CALENDAR - <http://www.camden.k12.ga.us/QuickLinks/20132014TestingCalendar/tabid/20495/Default.aspx>

COMPULSORY ATTENDANCE AGES - [Policy JBA](#)
 GRADING SYSTEMS - [Policy IHA](#)

Student Name: _____

Locker Number: _____

Homeroom Teacher: _____

Lunch Number: _____

DAILY SCHEDULE

	Class	Teacher	Room
1st Block			
2nd Block			
3rd Block			
4th Block			

CAMDEN MIDDLE SCHOOL-WIDE P.A.W.S. EXPECTATIONS

Expectations	Hallways / Transition	Cafeteria	Bus Port	Restroom	Classroom
Practice Safety	Keep hands, feet & objects to self Walk	Keep hands, feet & objects to self	Keep hands, feet & objects to self Walk when exiting building Report directly to bus	Keep hands, feet & objects to self	Keep hands, feet & objects to self Pass materials appropriately
Act Responsibility	Follow staff directions Use school tone & voice	Follow staff directions Use school tone & voice	Follow staff directions Use appropriate tone of voice	Do your business and get out	Follow staff directions in a timely manner Be prepared for class Keep hallway pass with you at all times
Work Towards Success	Keep hallways clean & clear	Keep tables & floor clean & clear	Board buses promptly	Keep floor, walls & sinks clean	Only eat when given permission Attend to personal needs prior to coming to class
Show Respect	Use appropriate language Observe others' personal space	Keep tables & floor clean & clear	Use appropriate language	Use appropriate language Respect privacy	Use appropriate language Remain in assigned area Keep hands & feet to yourself

CAMDEN MIDDLE SCHOOL MISSION STATEMENT

We will ensure a safe and caring environment where all students develop skills and gain knowledge necessary to be successful in life.

OUR STAFF BELIEVES

1. Everyone can learn.
2. Education is a major building block for success.
3. Education is the shared responsibility of the school, students, parents, and community.
4. Everyone deserves a safe learning environment.
5. Strength comes from diversity of people, resources, and programs.
6. Efficient and effective operations ensure a quality environment.]
7. Students deserve highly qualified, motivated, and talented teachers who hold high expectations.
8. Educators deserve to teach in a classroom free of disruptions and distractions.
9. Student success and independence are greatly impacted by effort and attitude.
10. Progress comes from willingness to change.

PARENTAL RESPONSIBILITIES

The board of education believes that the ultimate responsibility for a student's behavior rests with his/her parents. Students are to respect constituted authority, which includes obedience to school rules, regulations, and procedures. The board anticipates that parents will be concerned and cooperative in dealing with any behavioral problems that may arise and expects that this cooperation will be made apparent to the child. Therefore, one of the most significant objectives of discipline must be to develop with the individual student the desire to exercise his rights judiciously. To realize this objective, the school reserves the right to hold parental conferences, guidance conferences with the court, and the right to request schedule changes or psychological examinations and/or treatment.

LEAVING SCHOOL DURING SCHOOL HOURS

Early dismissals are discouraged, but if it becomes necessary for a student to leave school during the day, arrangements should be made before leaving home, and the procedure outlines below should be followed:

1. The student is to bring to the front office prior to 7:55 a.m. a note signed by his/her parents stating:
 - a. The time of early dismissal
 - b. The reason for early dismissal
 - c. The mode of transportation
 - d. The person providing transportation
2. The names of students who have permission to leave school will be written in the morning report, and at the appropriate time, they will be dismissed from class to report to the office to sign out.
3. No student is permitted to leave school early without signing out and being properly dismissed through the school office.
4. When a student returns to school the same day after checking out, he is to report to the office with a note from a doctor or dentist, sign in, and get a pass to class.
5. To relieve the school of liability, no student will be allowed to leave the school grounds during the school hours unless he has received prior written permission from his parents as set out in No. 1 above, or unless a parent comes to the school office and signs a written permission.
6. In case of illness, the student should report to the nurses' station. If the student's illness requires that he/she leave school, the parents will be called and the secretary may dismiss the student after the parents come and sign out the student.
7. No student will be allowed to leave campus with a person who is not so designated by the parent/guardian.
8. Students leaving campus **MUST** properly "sign-out" at the main office.
9. Students leaving campus will not be permitted to return that day unless accompanied by a parent, parent note, or a doctor/dentist appointment verification slip.

STUDENTS STAYING ON SCHOOL GROUNDS AFTER SCHOOL HOURS

Students are not allowed to remain on school grounds after school hours unless they are under the direct supervision of a teacher/coach. Students who are picked up by parents must be picked up by 3:30 p.m. Parents who do not get off work until after this time must make other transportation arrangements for their children. Repeated violators will be assigned to ride a bus. Students who have been suspended from the bus must be picked up prior to 3:30 p.m. Students who stay for after-school detention must be picked up at the designated time. Unauthorized students will not be under school supervision after 3:30 p.m. and must leave the school grounds. Emergency situations would need to be approved by the school administration.

SCHOOL ACTIVITIES

CMS CLUBS

Name of Club: PAWS for Reading Club **Sponsor Names:** Mrs. Shan Peters and Ms. Deborah Kennedy

Purpose or Mission of Club: To encourage reading and school and community service

Activities Planned for 2014-2015 school year: Helen Ruffin Reading Bowl, Student Book Fair Crew, and contributing toward the House of Learning project (Habitat for Humanity)

Eligibility: Students in grades 6, 7, and 8 who enjoy reading

Name of Club: Junior Beta

Sponsor Name: Dr. Julia McCollough

Purpose or Mission of Club: To promote the ideals of honesty, service, morality, ethical conduct, and leadership among CMS students, to reward meritorious achievement, and to encourage and assist students in continuing their education after high school

Activities Planned for 2014-2015 school year: Induction ceremony, participation in Academic Achievement Breakfast, individual community service, Relay for Life, Hat Day, sponsors one student dance, Teacher Appreciation Week – ice cream social, facility improvements at CMS

Eligibility: By invitation to students in grades 6, 7, and 8 who maintain 90% in all academic subjects with continuous exceptional behavior records

Name of Club: Science and Technology Club

Sponsor Names: See school website for names of sponsors

Purpose or Mission of Club: To promote a strong and life-long interest in science to middle school students

Activities Planned for 2014-2015 school year: fieldtrips, guest speakers, science fair project help, maintaining reptiles, aquarium, outdoor classroom cleanup and landscaping

Eligibility: Students in grades 6, 7, and 8

Name of Club: Fellowship of Christian Athletes

Sponsor Names: Coach Mark Lang and Mrs. Susie Stewart

Purpose or Mission of Club: To see the world impacted for Jesus Christ through the influence of athletes and coaches and to present to athletes and coaches and all whom they influence the challenge and adventure of receiving Jesus Christ as Savior and Lord, serving Him in their relationships and in the fellowship of the church

Activities Planned for 2014-2015 school year: Weekly huddles each Thursday morning and guest speakers

Eligibility: Students in grades 6, 7, and 8

All students are considered eligible for voluntary club participation. Please notify the grade level administrator if you wish to exclude your child from voluntary participation.

INTERSCHOLASTIC ATHLETICS

The purpose of the CMS athletic program is to provide qualified students an opportunity to participate in an extracurricular athletic activity that will foster physical skills, a sense of work and competence, a knowledge and understanding of the pleasure of sports, and the principles of fair play. However, we must remember that the athletic program is always secondary to our major task, which is academic instruction. Anytime there is a conflict between the academic program and the athletic program, the academic program always takes precedence.

Competitive Interscholastic Activities, Grades 6-12

Descriptor Code IDEA (3)

The board of education (“the board”) hereby adopts this policy regulating competitive interscholastic activities.

1. Each middle and high school principal shall regulate competitive interscholastic activities in her or her school and shall ensure that all staff members adhere to the school system’s athletic guidelines, this policy, and related rules of the State Board of Education. The principal may delegate responsibility for supervising one or more student activities and clubs to a member or members of the professional staff, provided such individuals must act under the principal’s direction.
2. A student wishing to participate in interscholastic activities must be enrolled full-time in the school system during the semester of participation.
3. Retention of students for athletic purposes is prohibited.
4. Each principal of a school covered by this policy shall maintain documentation of adherence to the requirements of the policy. The board is responsible for regulating competitive interscholastic activities in grades 6-8, and therefore adopts the middle grade requirements set forth in State Board Rule 160-5-1-.18 (Competitive Interscholastic Activities in Grades 6-12), as to student eligibility, physical examinations, and special provision.

PHYSICAL EXAMINATIONS

All students in grades 6-8 who participate in competitive interscholastic athletics and cheerleading shall have an annual physical examination prior to participation in any tryout, practice, or conditioning, whichever comes first. The physical examination form shall indicate approval for participation and be signed by a doctor of medicine or a doctor of osteopathy. The physical examination form shall include the date that the exam was performed (month, day, and year), the student’s name, and the physician’s signature.

GRADING SCALE

Revised August 10, 2010

Descriptor Code IHA

The following grading system shall be used in the Camden County Schools. No alterations of any nature may be made to the system.

Grading System for Grades 3-8

A – 90-100

B – 80-89 C – 70-79 F – Below 70

I – Not enough evidence to assign grade

CHEATING

Any time a student is caught cheating on graded schoolwork, the student will be given a zero for that work and the parent will be contacted. After a review of the incident, additional punishment may be assigned by the administration.

PROMOTION STANDARDS AND CRITERIA

Revised Feb. 14, 2012

Descriptor Code IHE

Grades 6-8

Students must pass language arts/reading, mathematics, science, social studies, and ½ of exploratory/connections classes.

Administrative Placement of Students

Any student who does not achieve the prescribed criteria above in each grade (K-8) may be referred to an administrative placement team which will consider the student's potential for success and make recommendations for placement in non-routine promotion-retention cases. Parents are to be invited to participate in this process. It is in the best interest of the student to be placed at the beginning of the school year; however, in some cases, the decision is made at semester to place students from an elementary school to a middle school. This decision must be made with the agreement of both the receiving and sending principals, and with parental involvement. If consensus between school and home cannot be reached, the principal's decision shall be the overriding decision.

Requirements for Grades 1-8 (Policy IHE)

Promotion of a student shall be determined as follows:

1. No student in grades five or eight shall be promoted to the next grade if the student does not achieve grade level on the Criterion Referenced Competency Tests (CRCT) in reading and mathematics, and meet local promotion criteria;
2. The school principal or designee may retain a student who performs satisfactorily on the CRCT, but who does not meet promotion criteria established by the Camden County Board of Education.

SAFETY

The rules of safety will be constantly emphasized in our school. Industry places a premium of safe workers. Many lives are lost and many workers suffer countless injuries when the rules of safety are ignored or flaunted. The following are general safety rules.

1. Obey warning and danger signs.
2. Horseplay, fighting, wrestling, or childish behavior has no place in this school.
3. Do not throw objects. Do not run in corridors.
4. Report all injuries, no matter how slight, to your instructor. An accident report will be completed on all injuries.

Dangerous behavior: Students who exhibit dangerous behavior, i.e. running in the halls, throwing objects, rough play, etc. will be subject to appropriate disciplinary actions.

STUDENT DROP OFF AND PICK UP

Students must not be dropped off at school before 7:15 a.m. Vehicles dropping off students should remain in single file of the drop-off lane which is closest to the sidewalk. Students should exit their vehicles on the side closest to the sidewalk to avoid them being placed in traffic lanes. Student must be escorted or acknowledged for permission by supervisors before crossing the drive when they are loading into vehicles parked across the drive in the visitor's parking spaces. Students should only be dropped off in front of the school. Students should not be picked up or dropped off in other areas of the campus.

DRESS CODE

A student shall not dress or groom himself or wear or use emblems, insignias, badges, or other symbols where the effect thereof is to distract unreasonably the attention of other students or otherwise to cause disruption or interference with the operation of the school. The principal, or other duly authorized school official, shall determine whether any particular mode of dress, apparel, grooming or use of emblems, insignias, badges, or other symbols result in such interference or disruption, and if this is the case, all students will be informed by announcement or posting at the school.

Students should always dress in a manner that does not disrupt the learning environment. Tank tops (also tank tops worn under jackets), mesh tops, unbuttoned shirts, and bare backs or midriffs are NOT allowed. Appropriate footwear must be worn at all times. Bedroom slippers may not be worn. Shoes must be tied and/or fastened.

Sleeveless clothing is allowed as long as the shoulders are covered and no undergarments are visible. Pants of appropriate size will be worn at the waist and zipped. Belts will be buckled, and undergarments must not be visible. Shorts or dresses are not to be excessively short or too tight. The standard for shortness (shorts, skirts, dresses) is as follows: the shortest part of the student's shorts or skirt (including slits) must not exceed 5" from the crease in the back of the knee when standing. Plunging necklines or excessively tight figured clothing is prohibited. Spandex or stretch pants are allowed provided the student has a skirt or shirt covering the spandex that meets the 5" rule as stated above. Students may not wear spandex or stretch pants/shorts as an individual clothing item.

Unusual or clownish dress is not permitted (i.e. pajamas or costumes). No spiked bracelets, belts, or gloves are to be brought to school. No large bulky finger rings or chains may be worn. This includes any type of chain that the principal feels could be used as a weapon. No hats, caps, sweatbands (unless for sporting event usage), sunglasses, or bandanas are to be brought to the school. Students may not wear clothes depicting or promoting violence, other anti-social behavior, sexual content, or alcohol/drug-related words or images. Rips in jeans and pants are allowed as long as there are no gaping holes revealing skin or underwear. **The final determination concerning this policy will rest with the principal of the middle school.** Students found to be in violation of the dress code policy will receive:

1st Offense: Warning

2nd Offense: 3 days lunch detention

3rd Offense: 1 day ISS

4th Offense: 3 days ISS

5th Offense: 2 days OSS

Further Offenses: school suspension

Students found to be out of dress code may be placed in ISS for the remainder of the school day.

ITEMS NOT ALLOWED AT SCHOOL

Since our purpose of coming to school is to study, the following items are to be left at home:

Cell phones, pocket pagers, radios, tape players, cassettes, CD's, and other electronic equipment	Any type of handheld games or tapes
Cameras	Water guns
Balloons	Skateboards or skates
Hair paint	Gum or candy
Any type of tobacco product	Baseball cards, football cards, etc.
Hats, bandanas, or caps	Fireworks*
Toy guns*	Stink bombs*
Aerosol cans	Chains
Toys of any description (i.e. yo-yo's)	Pepper spray, mace, tear gas, chemical sprays
Breath sprays	Knives, razor blades, or any other sharp object
Firearms, including starter pistols	Lighters, matches, or other flammable object
Pornographic material	Lasers
Any other items that cause a disruption of the learning environment	
*Minimum punishment shall be three days of ISS.	

Although hair spray, make-up, perfumes, colognes, after-shaves, and lotions may be brought to school, they are NOT to be used in the classroom. Book bags may be brought to school in the morning but must be stored in the locker during the day. They cannot be carried from class to class and may be subject to random search at any time.

SCISSORS: Scissors on campus for any reason will not be allowed. Any use of scissors will be limited to classroom use of teacher distributed scissors. The possession of scissors while at school will be considered a violation of the rule regarding the use or possession of dangerous weapons or instruments.

MORNING WORK PASSES AND MORNING MEDIA PASSES

Students must have hall passes to attend morning sessions with teachers before homeroom. Students must obtain passes the day before attending the morning session with teachers. All students going to the media center between 7:30 and 8:00 a.m. will need a Morning Pass to Media Center. Students may ask Mrs. Peters for the pass during the school day. Students visiting the media center in the mornings are asked to remain in the media center until the homeroom bell has rung. Any student not following these procedures will lose their media center pass.

CAFETERIA BEHAVIOR AND PROCEDURES

Students who wish to purchase their meals by the week are to pay on Monday during their lunch session. In order for a student to purchase an ice cream, they must first have a meal. It may be a school lunch or a sack lunch from home. Students are not to share food from school lunches. No carbonated beverages unless in a thermos are permitted at school. No glass containers are permitted at school. Students are not to move from seat to seat and are to sit in first available seat after passing the register. Students who do not receive a school lunch are to go directly to the next available seat without going through the lunch line. Throwing of food or any other objects will not be tolerated. Students are to enter the lunchroom through the doors nearest the stage and exit through the doors nearest the gym. Single file lines are to be used when waiting to be served and when putting food trays away. Student misbehavior during lunch period will result in placement in lunch isolation or other disciplinary action.

The policies above and many throughout the handbook can be viewed in their entirety by clicking on the blue policy link. Clicking on those links will take you to the (school/system) website. To view particular policies, follow the directions below.

1. Go to www.camden.k12.ga.us.
2. Hover your mouse over the "District" tab. When the drop down box appears, click on "Online Policy Manual."
3. Hover your mouse over the "Policies" tab. A drop down box will appear giving the alphabetical listing of each policy section.
4. Click on either of the alphabetical sections and each individual policy for that section will be displayed.

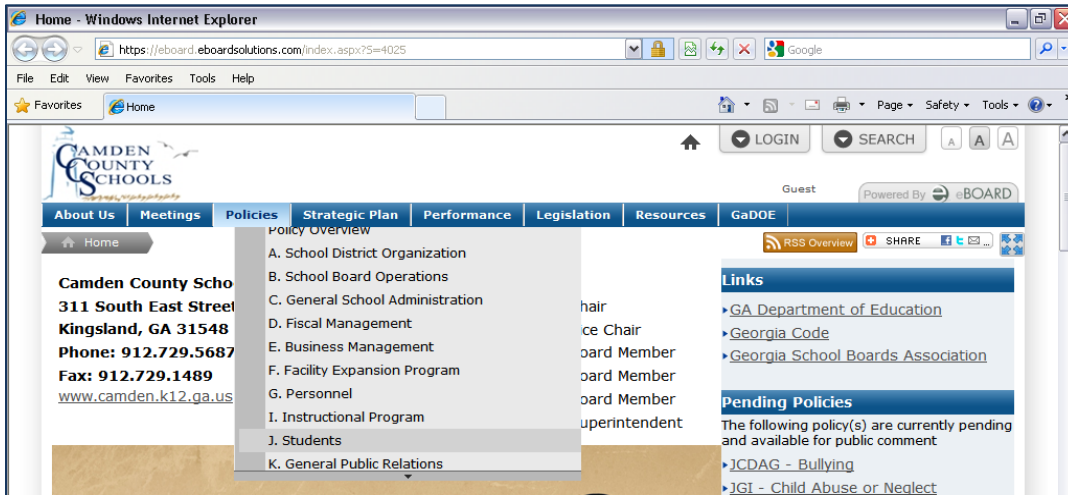
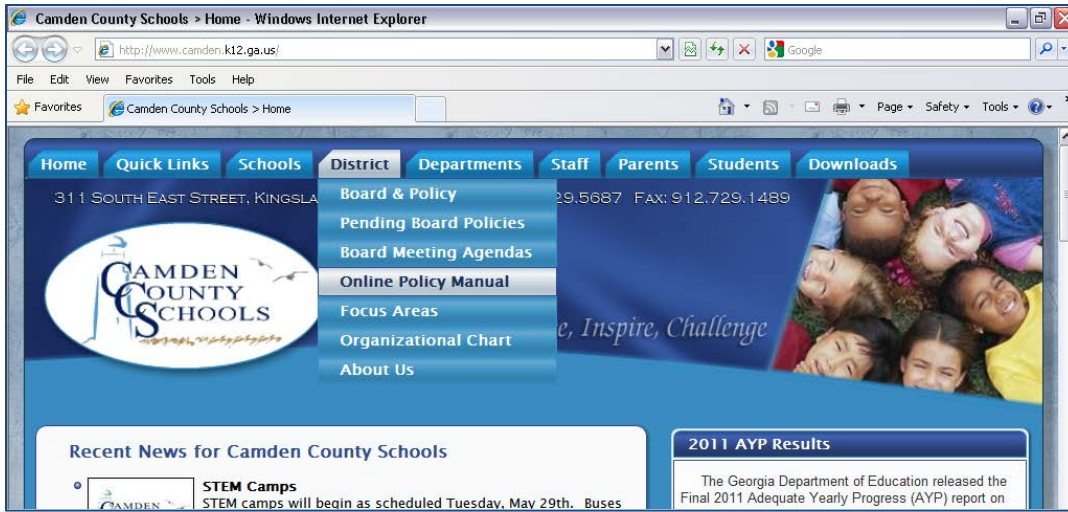

POLICIES NEW OR UPDATED DURING THE PAST FISCAL YEAR:

- [IDCH – Dual-Joint Enrollment –](#)
- [IHEB-R - Academic Achievement –](#)
- [JDE – Expulsion –](#)
- [JCDA-R - Student Behavior Code](#)
- [JCDAC - Student Drug Use](#)
- [JBC\(4\) - Awarding Units and Transferring Credits](#)
- [IHF - Graduation Requirements –](#)
- [JDD - Student Suspension –](#)
- [JDDA-R - Assignment to Alternative Program –](#)
- [JS-R - Student Fees, Fines and Charges -](#)
- [JGFGB - Concussion Management](#)

CAMDEN COUNTY SYSTEM CALENDAR 2014-2015

First Semester		Second Semester	
August 5, 2014	First Day of School	Jan. 7, 2015	First Day of 2 nd Semester
Sept. 1, 2014	Labor Day Holiday	Jan. 19, 2015	Martin Luther King Holiday
Oct. 13, 2014	Columbus Day/Student Holiday	Feb. 16, 2015	President’s Day Holiday
Nov. 10, 2014	School Holiday	March 6, 2015	Student Holiday
Nov. 11, 2014	Veteran’s Day/ School Holiday	March 30 – April 3, 2015	Spring Holidays
Nov. 24–28, 2014	Thanksgiving Holidays	May 22, 2015	Last Day / Graduation
Dec. 19, 2014	Last Day of 1st Semester		

EMERGENCY CONTACT

Guardians are to maintain an up-to-date record of address, telephone number, employment, emergency contact persons, or persons authorized to sign out your child.

VISITORS

All visitors to a school or school campus must report immediately to the main office of the school. Visitors may not go beyond the office without permission. Students are not allowed to bring nor have other children as visitors at school.

BREAKFAST AND LUNCH - <https://www.mynutrikids.com/Login.aspx>

All students are encouraged to participate in our nutritious breakfast and lunch program.

	<u>Breakfast</u>	<u>Lunch</u>	<u>Reduced Lunch</u>	<u>Extra Juice/Milk</u>
Elementary	free	\$1.75	\$0.40	\$0.30
Middle	free	\$1.80	\$0.40	
High	free	\$2.25	\$0.40	
Adult Staff	\$2.00	\$3.00		
Visitors	\$2.25	\$4.00		

Students who eat breakfast at school and are transported by parents must report 15 minutes before school begins. In the event of a late arriving bus, students on that bus will be allowed to eat breakfast.

Payment: All monies will be collected in the school's cafeteria. Free and reduced meal applications will be sent home the first day of school. PLEASE return the free and reduced application *regardless* of your child's participation in the program. These applications assist the system in obtaining federal funding for all schools.

Charges for meals: Students are limited to three (3) charges. Students will not be allowed to purchase a school lunch until overdue charges to the cafeteria. Students will not be allowed to charge during the last 30 days of school.

FOOD ALLOWED TO BE BROUGHT ON CAMPUS

The following procedures have been developed to provide for the health and safety of all students during the school day.

1. No homemade food items will be allowed to be brought on campus to be distributed to students.
2. Parents may bring in food items purchased in a store provided they are packaged and an ingredients label is available.
3. Parents must make arrangements with their child's teacher at least one school day prior to bringing in snacks or food items for a class.
4. Parents must check with their child's teacher for a list of snacks appropriate for that particular classroom.
5. Parents and teachers will be provided with a list of "Healthy School Celebration" options and some suggestions for celebrations that do not include food items.

PLEDGE OF ALLEGIANCE /MOMENT OF REFLECTION - [Policy IKD](#)

In compliance with Georgia law, each school in Camden County shall provide students the opportunity to recite the Pledge of Allegiance to the United States of America flag and participate in a moment of silent reflection.

PARENT/SCHOOL COMMUNICATION

When parents have questions or concerns about their children, the first line of communication should be the classroom teacher. If concerns or questions are not resolved, contact with the school counselor or administrator is appropriate. Questions or concerns about school policies or procedures should be directed to administrators. If parents still have concerns about the outcome or response from school administrators, they need to contact system level personnel based on the specific concerns at 912-729-5687.

PARENTLINK

In an effort to provide efficient communication to parents, Camden County Schools will continue to use the ParentLink calling system providing the daily notification of student absences at all school levels. In elementary and middle schools, student attendance will be taken at the start of school. Phone calls indicating student absences will begin at 9:00 a.m. A parent/guardian transporting a student to school and arriving after the start of school may receive a phone call indicating the student is absent. These students will be marked tardy for the day, but because of the timing of the tardy, an absence call may go out.

DIRECTORY INFORMATION

Camden County Schools has designated the following information as directory information: student's name, address, and telephone number; date and place of birth; participation in official school clubs and sports; weight and height of student if he/she is a member of an athletic team; dates of attendance at the school system schools; awards received during the time enrolled in the Camden County School System. Unless otherwise requested within 10 days after enrollment, the information above may be disclosed to the public.

USE OF STUDENT PHOTOGRAPHS/VIDEO FOOTAGE

The Camden County School System utilizes student photographs/video footage to recognize students for awards and achievements and to publicize school activities and events. Unless otherwise requested within 10 days after enrollment, photographs/video footage of your child or you may be used for the purposes indicated above.

CHILD STUDY TEAM

Consistent with the agreement reached in [Georgia State Conference of Branches of NAACP v. Georgia](#) (Ollie Marshall Case), the board of education believes that the child study team (CST) is an effective tool for students experiencing problems in school and for assisting teachers in addressing identified problems. The CST provides services through the regular education program, including instructional planning and consultation that includes those individuals responsible for the educational well-being of the instructional process for planning educational delivery systems.

GUIDANCE SERVICES

Guidance services help provide personal opportunities and specialized staff services so that each individual can develop to the fullest of his/her

abilities and capacities. The counselors are available for consultation with students, teachers, and parents concerning students' problems. Personal counseling is one of the main functions of the department. Students with problems come either voluntarily or by referral from teachers, administrators, or parents.

SOCIAL WORK SERVICES

School Social Work Services are available to all Camden County students and their families. Occasionally students may experience difficulties which negatively affect their behavior, school attendance and/or academic performance. School social workers provide assistance in helping families and students bridge the channels between home, school, and community resources in order to improve student's educational opportunities. School personnel can make referrals to social workers when there is the need for additional support. Parents and students may also contact the school social worker at 729-5687 for assistance.

SURVEYS

TITLE X - MISCELLANEOUS

PART A - MISCELLANEOUS PROVISIONS

SECTION 1017, PROTECTION OF PUPILS PROTECTION OF PUPIL RIGHTS

[Section 439 of the General Education Provisions Act \(20 U.S.A. 1232g\)](#) is amended to read as follows:

1. All instructional materials, including teacher's manuals, films, tapes, or other supplementary material which will be used in connection with any survey, analysis, or evaluation as part of any applicable program shall be available for inspection by the parent/guardians of the student.
2. No student shall be required, as part of any applicable program, to submit to a survey, analysis, or evaluation that reveals information concerning political affiliations; mental and psychological problems potentially embarrassing to the student or his/her family; sex behavior and/or attitudes; illegal, anti-social, self-incriminating and demeaning behavior; critical appraisals of other individuals with whom respondents have close family relationships; legally recognized, privileged or analogous relationships, such as those of lawyers, physicians, and ministers; or income (other than that required by law to determine eligibility for participation in a program or for receiving financial assistance under such program) without the prior consent of the student (if the student is an adult or emancipated minor), or in the case of an unemancipated minor, without the prior written consent of the parents.
3. Educational agencies and institutions shall give parents and students effective notice of their rights under this section.
4. ENFORCEMENT - The Secretary take such action as the Secretary determines appropriate to enforce this section, except that action to terminate assistance provided under an applicable program shall be taken only if the Secretary determines that there has been a failure to comply with such section or compliance with such section cannot be secured by voluntary means.
5. OFFICE AND REVIEW BOARD - The Secretary shall establish or designate an office and review board within the Department of Education to investigate, process, review, and adjudicate violations of the rights established under this section.

TITLE I - TITLE I PARENTAL INVOLVEMENT POLICY

Title I is a federally funded program that provides services to schools based on student economic need, which is determined by the free or reduced lunch status. School improvement and parent involvement plans are required by all Title I schools and are available at the school or on school websites. Below are links describing the plans:

[Improving the Academic Achievement of the Disadvantaged](#)

[ESEA Section 1118, NCLB](#)

FAMILY EDUCATIONAL RIGHTS AND PRIVACY ACT (FERPA)

Under the Family Educational Rights and Privacy Act (20 U.S.C. 1232g) the "Act"), you have a right to

1. Inspect and review the education records of a student who is your child, or in the case of a student who is eighteen years of age (18) or older, your own education records;
2. Request the amendment of the student's education records to ensure that they are not inaccurate, misleading, or otherwise in violation of the student's privacy or other rights;
3. Consent to disclosures of personally identifiable information contained in the student's education records, except to the extent that the act and the regulations promulgated pursuant to the Act authorize disclosure without consent.
4. File with the United States Department of Education a complaint under 20 C.F.R. 99.64 concerning the alleged failures by the Camden County Board of Education to comply with the requirements of the Act or the regulations promulgated thereunder;
5. Obtain a copy of the policy which the Board of Education has adopted regarding access to the records. Copies of this policy may be obtained by contacting the Administrative Office of the Camden County Board of Education at 311 S. East Street, Kingsland, Georgia 31548, (912) 729-5687.

ADMINISTRATION OF MEDICINES

Schools will not administer medicine without a medical authorization form which may be completed at the school.

COMMUNICABLE DISEASE – [Policy JGCCA](#)

A student who has a dangerous communicable disease that poses a substantial threat to the health or safety of the school community may be removed from the school by the principal on the approval of the superintendent until such student no longer poses a threat. This also applies to those children who are found to have head lice, chicken pox, impetigo, unknown rashes, ringworm, and conjunctivitis. The Camden County Board of Education has adopted a nit free policy and proper procedures should be followed before students are allowed back in school.

ACCIDENTS AND INSURANCE - <http://www.markelinsurance.com/Pages/Default.aspx>

The school is responsible only for immediate first aid. Camden County Schools does not pay any medical or hospital bill incurred as a result of an accident to a student at school. The parent or guardian is responsible for the payment of such bills. We urge you to consider the protection afforded through school insurance. You will be given information regarding various insurance plans during the first week of school. All accidents, no matter how minor, should be reported to the teacher immediately. First aid for minor injuries is available in the school clinic. In the case of severe accidents or acute illness, emergency care will be given and parents will be notified.

BICYCLE SAFETY - [O.C.G.A. 40-6-296](#) Georgia law requires children under the age of 16 to wear a helmet.

FIRE DRILLS - [Policy EBBC-R](#) Georgia law requires schools to conduct fire drills monthly. Procedures are established at each school.

EMERGENCY CLOSINGS - [Policy AFC](#) and [Policy AFC-R](#)

In the event of foul weather that would prevent the safe transportation of students to the schools or any other emergency situation that would affect the safety or well-being of students, or otherwise make it impractical or impossible for the normal operation of school, the superintendent, in collaboration with the board of education, will close the schools until said emergency condition no longer exists. In the case of sudden change of weather conditions, the safety of students shall be the number one priority. Decisions concerning the early or late dismissal of students will be determined by the severity of the weather conditions and surrounding circumstances. If it is determined that students will be dismissed other than at the regular time of dismissal, all efforts will be made to contact the local media. The school system requests parents stay tuned to local radio and television stations during inclement weather. Since it would be impossible to individually contact parents, the school system will make every effort to inform these stations if dismissal times are changed.

PARENT PROTOCOL DURING SCHOOL CRISIS

Camden County Schools works closely with local emergency agencies to establish protocols in the case of a crisis. Each school has developed an Emergency Operations manual in compliance with Georgia law which identifies roles and responsibilities. Parents are urged to follow all directions at the site. You will be instructed to the Family Reunification Site for child pickup. This is the only area designated for parent/student reunification. Please do not approach emergency personnel. Anyone picking up students must have proper picture identification and sign for the children's release.

SECLUSION/RESTRAINT – [Policy JGF\(2\)](#)

The State Department of Education approved Rule 160-5-1-.35 Seclusion and Restraint for All Students, Code JGF(2), O.C.G.A. 20-2-240. The use of physical restraint is prohibited in Georgia public schools and educational programs except in those situations in which the student is an immediate danger to himself or others and the student is not responsive to less intensive behavioral interventions including verbal directives or other de-escalation techniques. All physical restraint will be immediately terminated when the student is no longer an immediate danger to himself or others or if the student is observed to be in severe distress. The written policies governing the use of physical restraint are outlined in the online policy manual.

VIDEO SURVEILLANCE – [Policy JG\(1\)](#)

The Camden County Board of Education authorizes the use of video camera surveillance on school grounds and in school transportation vehicles in accordance with state policy.

ASBESTOS PLAN

This is to notify all persons who work or attend class in the Camden County Schools that management plans have been developed for friable and non-friable asbestos containing building materials for all buildings in this school system. The management plans show the location of asbestos containing material and assumed asbestos containing material. Anyone may review or retain a copy of these plans. Individual school plans are on file in the principal's office at each school. All plans are on file at the Administrative Office, Maintenance and Operations, Camden County Board of Education, 311 S. East Street, Kingsland, Ga. 31548.

ABSENCES AND EXCUSES – [Policy JBD](#) and [Policy JBD-R](#)

Students shall be in attendance at public schools in accordance with requirements of the compulsory school attendance law and for the number of full-length days prescribed by law.

A. In accordance with the authority granted by the compulsory school attendance law and the following guidelines, excused absences shall be defined by the policies and regulations of the school system board of education.

Children may be temporarily excused from school when

1. personally ill and attendance in school would endanger their health or the health of others;
2. in their immediate family, there is a serious illness or death which would reasonably necessitate absence from school;
3. observing special and recognized religious holidays of their faith;
4. mandated by order of governmental agencies (Examples: pre-induction physical examination for service in the armed forces or a court order);
5. conditions render attendance impossible or hazardous to student health or safety;
6. the student registers to vote (one day only);
7. attending college/career visitations according to the administrative regulations provided in JBD-R; or
8. to visit with a military parent or guardian who has been called to duty for or is on leave from overseas deployment to a combat zone or combat support posting. (There will be a maximum of five school days excused for this purpose per school year.)

B. Local boards of education shall count students present when they are serving as pages of the General Assembly.

C. Absences shall not penalize students' grades; however, all make-up work must be completed.

When there is a cause necessitating an individual student to be excused from school for a portion of the school day, the student shall be released from school only to his parent(s), to a person properly identified to school authorities, or upon request by letter or telephone from the parent(s).

MAKE UP WORK WHEN ABSENT - [Policy JBD](#)

Grades 6-8

Students who are absent from school will be permitted to make up any work missed during the absence. They are allowed the number of days absent, plus one, to make up the missing assignments. Missing work that would lead to a failing grade should be assigned an "I" until the work has been completed. A valid written excuse must be turned in to the attendance clerk within two school days of the last day of the absence or the

absence will be considered unexcused. Students who are placed on official hospital homebound status are not subject to this rule during the time they are officially listed as hospital homebound students. Hospital homebound parents/students must comply with state and local guidelines as they apply to the Hospital/Homebound Instruction Program. Exceptions to this policy will be permitted on a case by case basis as determined by the principal or his/her designee. Once a final decision is rendered by the principal or his/her designee, no further appeals will be heard. The principal or his/her designee is responsible for notifying the parent of the final decision.

Consequences for Excessive Absences Grades 6-8

Any student who misses more than seven (7) days (excused and/or unexcused) during a given semester may be ineligible for participation in any extracurricular activities held during the remainder of the semester in which the absences took place. Examples: athletic contests, fine arts productions and competitions, dances, prom, literary competitions, band competitions, etc.

HOSPITAL/HOMEBOUND PROGRAM – Policy JBD

Students who have medical problems that prohibit them from attending school for an extended period of time are eligible for the services of the hospital/homebound program. Under this program, the school will provide a teacher to secure assignments/materials from the student's classroom teacher and visit the student in his/her home to provide individual instruction while the student is incapacitated. While a student is being served under this program, he/she will be counted as present in all of his/her classes.

The basic requirements for eligibility in the program include:

1. student must have a certified doctor's statement indicating said student will not be able to attend school for at least ten (10) school days,
2. student's illness must not be communicable, and
3. parents must provide medical updates after the initial 4 week service.

Parents are encouraged to contact the school counselor for additional information or an application for this program.

TARDIES – DISMISSALS

Students who come to school late must report to the office and obtain a late pass. A child may be dismissed early during the school day with parental permission and school approval. The student must be signed out in the front office before leaving. An authorized adult must sign a student out of school. Picture identification is required when picking up a student early from school and may be requested when picking up car riders. To ensure the safety of all students, please limit telephoned transportation changes to emergencies or extenuating circumstances only. Calling to make afternoon transportation changes should not be common practice. Students are not allowed to sign themselves out for the day.

PROGRESS REPORTS & REPORT CARDS

Progress reports and report cards shall be distributed according to the adopted school calendar.

HONOR ROLLS – Policy IHD

Students who achieve at an exceptionally high level shall be named to the honor rolls of Camden County Schools.

GIFTED EDUCATION - Policy IDDD

The board of education will maintain a school program designed specifically to meet the needs of intellectually gifted students in accordance with State Board of Education Policy 160-4-2-.38. Eligibility for gifted program placement is based upon four categories for assessment (mental ability, achievement, creativity, and motivation) and the performance standards that must be achieved in each for a student to become eligible for gifted education services

INTERNET USAGE BY STUDENTS - Policy IFBG and Policy IFBG-R

Access to the school's Internet is provided for educational purposes and research consistent with the school system's educational mission and goals. Parents shall be required to sign the Internet Network Access Agreement form allowing their students to access the Internet. All students shall also be required to sign said form affirming that they have read and understand the administrative procedure on "Student Internet and Appropriate Use" and understand the consequences for the violation of said administrative procedure.

SEX EDUCATION AND AIDS PREVENTION INSTRUCTION WAIVER

Parents have the right to elect, in writing that their children not participate in health curriculum which includes sex education and AIDS prevention instruction. Waiver forms are available from the school. Alternative assignments in a separate location may be provided.

INSTRUCTIONAL MATERIALS – Policy JS-R

Instructional Materials (i.e. textbooks, electronic devices, other) are furnished free of charge. However, should a student lose or damage an item, he/she shall reimburse the system. The cost of the item shall be determined by school or district personnel.

TRANSFER AND WITHDRAWAL

If your family plans to move to another location in Camden County, outside of Camden County, or out of state during the school year, you will need to notify the school office at least two (2) weeks before you withdraw or transfer your child. Official forms will need to be completed and all textbooks and library materials accounted for before the child transfers.

SCHOOL FUNDRAISING ACTIVITIES

Students may participate in approved fundraising activities as a part of school clubs and organizations or as part of a school-wide fundraising event. Monies raised in a club are used to promote the activities of the club. Monies raised in a school-wide fundraising campaign may be used for student activities and events, purchase of awards, funding awards ceremonies, faculty and staff recognition, and other activities and events which promote the students and the school. Students are not encouraged to go door to door when involved with fund raising events.

NOTICE REGARDING TEACHER/PARAPROFESSIONAL QUALIFICATIONS

In compliance with the requirements of the Elementary and Secondary Education Act the Camden County School System informs parents that you may request information about the professional qualifications of your student's teacher(s). The following information may be requested:

- 1) Whether the teacher has met the Georgia Professional Standards Commission requirements for certification for the grade level and subject areas in which the teacher provides instruction;
- 2) Whether the teacher is teaching under an emergency or other provisional status through which Georgia qualifications or certification criteria have been waived;
- 3) The college major and any graduate certification or degree held by the teacher;
- 4) Whether the student is provided services by paraprofessionals, and if so, their qualifications.

If you wish to request information concerning your child's teacher's qualifications, please contact the principal of the school.

EQUAL EDUCATION OPPORTUNITIES - [Policy JAA](#)

The board of education does not discriminate in its educational program. All programs are open to anyone regardless of sex, race, creed, color, or national origin. The board of education adheres to Title IX, Title VI of the Civil Rights Act of 1964, Title II of Vocational Education Amendments of 1976, Title VII of the Civil Rights Act of 1964, Title XXIX of the Age Discrimination Act of 1976, and Section 504 of the Rehabilitation Act of 1973, and any amendments to those acts.

In keeping with the board's commitment and the requirement of applicable state and federal law, the board and staff will strive to remove any vestige of discrimination in employment, assignment, and promotion of personnel; in educational services and opportunities offered students; in location and use of facilities; in educational materials; and in all business transactions conducted by the board.

DRESS CODE

A student shall not dress, groom, wear, or use emblems, insignias, badges, or other symbols where the effect is distracting to other students or causes disruption or interference with the operation of the school environment. The principal or other duly authorized school official shall determine whether any particular mode of dress, apparel, grooming or use of emblems, insignias, badges, or other symbols result in such interference or disruption. The final determination concerning this policy will rest with the principal. Parents will be called and asked to bring a change of clothing to school when a student has violated the dress code.

ITEMS NOT ALLOWED AT SCHOOL

Items that are either not needed at school or are disruptive to the learning environment are to be left at home. School administrators will make the final determination on items not allowed. Cell phones provided by parents for their children are not to be used during school hours.

STUDENT REPORTING OF ACTS OF SEXUAL ABUSE OR SEXUAL MISCONDUCT

Any student (or parent or friend of a student) who has been the victim of an act of sexual abuse or sexual misconduct by a teacher, administrator or other school system employee is urged to make an oral report of the act to any teacher, counselor or administrator at his/her school.

PROGRESSIVE DISCIPLINE PROCESS

A progressive discipline process is an integral part of an effective school system. It helps correct student behavior and helps bring it within acceptable standards, ensuring a safe and productive school. The goal of progressive discipline has three components: 1. To reform the student and bring his or her conduct within acceptable standards; 2. To deter other students from engaging in similar conduct, and 3. To maintain control over the school as a whole and maintain school standards.

SCHOOL GUIDELINES FOR STUDENT BEHAVIOR

At all times in the school setting students are expected to respect themselves, the adults at the school, other students and their property, and school property. This applies to anytime the student is at school events or on school property, including the school bus. Teachers will review behavioral expectations for all areas of the school.

STUDENT BEHAVIOR CODE - [Policy JCDA-R](#)

PART A - PURPOSE

The purpose of this code is to provide students in the Camden County School System an effective and safe learning environment. This has been prepared in accordance with the discipline procedures of the Camden County School System. It contains information for school personnel, students, and parents. Included is an outline of expected behaviors and the consequences relating to various violations. Expected behavior is behavior that promotes learning and encourages maturity during the school day, as well as during all school related activities. Students and their parents need to know and understand this code in order to achieve these goals. Students should:

1. Participate fully in the learning process. Students need to report to school and class on time, attend all regularly scheduled classes, remain in class until excused or dismissed, pay attention to instruction, complete assignments to the best of their ability, and ask for help when needed.
2. Avoid behavior that impairs their own or other students' educational achievement. Students should know and avoid the behaviors prohibited by this code, take care of books and instructional materials, and cooperate with others.
3. Show respect for the knowledge and authority of teachers, administrators, and other school employees. Students must obey reasonable directions, use acceptable and courteous language, avoid being rude, and follow school rules and procedures.
4. Recognize and respect the rights of other students and adults. All students should show concern for and encouragement of the educational achievements and active participation of others.

Disciplinary actions for violations of expected behaviors will include appropriate hearings and reviews. In all cases, the rights of individuals will be ensured and protected. The Camden County School System will make every reasonable effort to administer the discipline code consistently in all schools. When applicable, individualized plans (i.e. IEP, 504, and CST) will be reviewed for appropriate consequences. Parent involvement through conference is the most desirable avenue for correcting behavioral problems and will be used when possible. Conferences may stand alone or may be used in conjunction with other forms of discipline. Other disciplinary actions subject to the discretion of the principal may include any or all of the following: conferences (may include student, teacher, parents, or outside agencies), detention, work assignments, suspension of privileges,

corporal punishment, placement in the alternative school, OSS (1-10 days), or referral to law enforcement. The State of Georgia has written a law which encourages parents and guardians to inform their children on the consequences, including potential criminal penalties, of underage sexual conduct and crimes for which a minor can be tried as an adult.

Discipline Glossary & Law Violation Terms – see policy link for definitions - [Policy JCDA-R](#)

STATEMENT OF STUDENT MISCONDUCT

These rules are designed to notify students as to the types and range of behaviors that are unacceptable; nevertheless, every specific variation of the prohibited conduct may not have been included. Consequently, students should expect to be disciplined for misconduct. A specific rule need not be written for every conceivable variation of behavior that directly affects the orderly mission of the school.

Disciplinary Action Plan

Depending upon the age of the student, the administration will choose the age-appropriate discipline plan. Progressive discipline processes and types of consequences used may vary depending upon whether the student attends a high school, middle school, or elementary school.

The Disciplinary Action Plan will be applied as a progressive process. Student discipline is assigned based on the severity and/or frequency of code violations. This means that a serious or major offense should result in a higher level of discipline even if the offense is the first of that kind. Repeated code violations result in the application of higher levels of discipline as determined by the principal or designee.

CONSEQUENCES OF STUDENT MISCONDUCT

A student could be referred to a disciplinary tribunal which may result in long-term suspension or expulsion; and, depending upon the severity of the offense, juvenile court or law enforcement may be contacted. Administrators must acquire parental permission before administering corporal punishment.

STUDENT BEHAVIOR CODE AND CONSEQUENCES

The following rules apply while students are:

1. on the school grounds at any time;
2. off the school grounds at a school activity, function, or event;
3. enroute to and from school or to or from a school activity, function, or event, on school transportation;
4. off the school grounds while the student is in attendance at any school function, or is engaged in
5. activity that could have a direct effect on the orderly function of the school, or is otherwise subject to
6. the jurisdiction of school authorities; and/or
7. off the school grounds when the misconduct is directed at a school student or employee and is related to the victim's school affiliation or when the off-campus misconduct directly affects the safety and welfare of the school community or the orderly mission and function of the school.

RULE 1 - DISRUPTION AND INTERFERENCE WITH SCHOOL

No student shall:

- a. pull fire alarm, set fire to, attempt to set fire to, or otherwise damage any school building or property;
- b. occupy or block any area of the campus, prevent or attempt to prevent students from attending a class, school activity, or event;
- c. except under the direct instruction of the principal, block or attempt to block normal pedestrian or vehicular traffic on a school campus or adjacent grounds;
- d. in any manner, by the use of violence, noise, force, coercion, threat, intimidation, fear, passive resistance, insult, or other disorderly conduct, intentionally or unintentionally cause the disruption of any lawful mission, process, or function of the school, including the teacher's ability to conduct his/her class, or engage in any such conduct for the purpose of causing the disruption or obstruction of any lawful mission process or function;
- e. refuse to identify himself/herself upon request of any teacher, principal, superintendent, school bus driver, or other school personnel;
- f. incite, advise, or counsel other students to engage in prohibited acts or violate any rules of the Student Behavior Code;
- g. be on campus or enter the premises of a school without proper authorization of the superintendent, principal, or other school personnel;
- h. fail to comply with reasonable verbal or written directions, rules, regulations, or commands of teachers, student teachers, substitute teachers, paraprofessionals, principals, school bus drivers, or other authorized school personnel;
- i. dress, groom, wear, or use emblems, insignia, badges, or other symbols where the effect thereof is to distract the attention of other students or cause disruption or interference with the operation of the school. The principal or other duly authorized school official shall determine if symbols result in such interference or disruption as to violate this rule. Rules concerning dress codes and procedures will be discussed in more detail in each school's student handbook.

RULE 2 - DAMAGE, DESTRUCTION, OR MISUSE OF SCHOOL PROPERTY OR EQUIPMENT

A student shall not cause or willfully or maliciously attempt to cause damage or vandalism to school property or alter/misuse school technological equipment or hardware, including accessing unauthorized areas on the computer. A student shall not steal or attempt to steal school property. A student shall not possess, sell, use, buy, or transmit stolen school property or attempt to possess, sell, use, buy, or transmit stolen school property. This includes, but is not limited to larceny/theft of school property; computer trespass (accessing unauthorized areas on the computer/software); marking, defacing, or destroying school property; arson; and breaking and entering and burglary

RULE 3 - DAMAGE, DESTRUCTION, OR MISUSE OF PRIVATE PROPERTY

A student shall cause or willfully or maliciously attempt to cause damage to private property or steal or attempt to steal private property either off school grounds or on the school grounds or during a school activity, function, or event off school grounds. Further, off school grounds, a student shall not cause or attempt to cause damage to private property belonging to a school employee where such theft or damage is because of or due to or a result of that school employee's performance of his/her official duties. A student shall not sell or attempt to sell or buy personal property on

school grounds. This includes, but is not limited to, damage or vandalism of private property (including marking, defacing, or destroying); theft of private property; possession of stolen private property; use of stolen private property; sale of stolen private property; purchase of stolen private property; transmission of stolen private property; arson; breaking and entering and burglary; larceny/theft; motor vehicle theft; and robbery (threat or battery is involved).

RULE 4 - ABUSE, THREATS, INTIMIDATION, ASSAULT, OR BATTERY ON A SCHOOL EMPLOYEE

A student shall not:

- a. make oral or written contact or symbolic gesture or contact of a threatening or provoking nature to a school employee or in the presence of a school employee. This includes, but is not limited to, oral threat, written threat, symbolic gesture, insult, use of vulgar or profane language directed towards a school employee, ethnic slur, racial slur, sexual slur, religious slur, and harassment.
- b. cause or attempt to cause physical injury or behave in such a way that could reasonably cause physical injury or make physical contact of a threatening or provoking nature to a school employee. Examples include, but are not limited to, behavior causing physical injury to employee, physical contact of a threatening or provoking nature to employee, and physical assault or battery.

This rule also applies off school grounds when the misconduct by the alleged perpetrator is due to or because of or a result of the school employee's performance of his/her official duties.

A Disciplinary Tribunal Panel will determine all issues of fact and intent relative to incidents of alleged physical violence toward a teacher or school employee. The tribunal shall submit its findings and recommendation to the Camden County superintendent for imposition of punishment. The Board of Education may follow the recommendations of the tribunal or impose penalties not recommended by the tribunal.

A student found by a tribunal to have committed an act of physical violence against a teacher, school bus driver, school official, or school employee involving intentional physical contact of an insulting or provoking nature shall be disciplined by expulsion, long-term suspension, or short-term suspension. In cases where the physical violence involves intentionally making physical contact which causes physical harm (unless such contact is in self-defense), the student shall be expelled from the school system for the remainder of the student's eligibility to attend public school. It is further mandated that students who are found guilty of the "causing physical harm" variety of physical violence be referred to juvenile court with a request for a petition alleging delinquent behavior. The Board of Education has some discretionary power regarding students in kindergarten through grade 6 since there is no alternative school for students in those grades.

Any person who commits the offense of battery against a teacher or other school personnel engaged in the performance of official duties or while on school property shall, upon conviction thereof, be punished by imprisonment for not less than one nor more than five years or a fine of not more than \$10,000.00, or both. (Georgia Code 16-5-23.1).

RULE 5 - ABUSE, THREAT, INTIMIDATION, ASSAULT, OR BATTERY BY A STUDENT ON ANOTHER STUDENT OR TO ANY OTHER PERSON NOT EMPLOYED BY THE SCHOOL

A student shall not:

- a. Make oral or written threatening, harassing, or intimidating remarks or symbolic gestures toward any student, which threaten the safety or well-being of that student or have the likelihood of provoking a fight. This includes, but is not limited to, oral threat/intimidation, written threat, symbolic gesture, bullying, insult, use of vulgar or profane language directed towards another student, ethnic slur, racial slur, sexual slur, religious slur, harassment, sexual harassment or violence, disrespectful conduct, and arguing.
- b. Cause or attempt to cause physical injury or behave in such a way as could reasonably cause bodily injury to any person. A student shall not engage in any behavior which threatens the safety or well-being of another person or has the likelihood of provoking a fight. This includes, but is not limited to, gesturing; posturing; fighting; insult; the use of profanity or ethnic, racial, sexual, or religious slurs; or harassment. This includes, but is not limited to, the following:
 - 1) pushing and shoving (attempting to fight, pre-fight confrontation);
 - 2) fighting (mutual participation in a fight where there is no one offender or major injury);
 - 3) battery (when one individual physically attacks or beats up on another individual against his or her will);
 - 4) behavior causing physical injury to another student;
 - 5) physical contact of a threatening or provoking nature to another student;
 - 6) aggravated physical assault or battery;
 - 7) homicide; and
 - 8) kidnapping (seizure, transportation, and/or detention of a person against his/her will).

NOTICE: OFFICIAL CODE OF GEORGIA

BULLYING – Policy JCDAG

The Camden County Board of Education believes that at all students can learn better in a safe school environment. Behavior that infringes on the safety of students will not be tolerated. Bullying, as the term is defined in Georgia Law, of a student by another student is strictly prohibited. Such prohibition shall be included in the Student Code of Conduct for all schools within the school system.

Bullying is defined as follows: An act which occurs on school property, school vehicles, at school related functions or activities, or by use of data or software that is accessed through a computer, computer system, computer network, or other electronic technology of a local school system, that is:

1. Any willful attempt or threat to inflict injury on another person, when accompanied by an apparent present ability to do so;
2. Any intentional display of force such as would give the victim reason to fear or expect immediate bodily harm; or
3. Any intentional written, verbal, or physical act, which a reasonable person would perceive as being intended to threaten, harass, or intimidate, that:
 - a. Causes another person substantial physical harm within the meaning of Code Section 16 -5-23.1 or visible bodily harm as such term is defined in Code Section 16-5-23.1;

- b. Has the effect of substantially interfering with a student's education;
- c. Is so severe, persistent, or pervasive that it creates an intimidating or threatening educational environment; or
- d. Has the effect of substantially disrupting the orderly operation of the school.

Incidents which occur at the bus stop, and are reported, will be investigated by school administrators. The supervision at the bus stop rests with parents of those children at that bus stop.

Acts of bullying shall be punished by a range of age appropriate consequences through the progressive discipline process, as stated in the Code of Conduct. Such consequences shall include, at a minimum and without limitation, disciplinary action or school counseling, as appropriate under the circumstances. Any student in middle school committing an act of bullying for the third time during their middle school years will be assigned to the Ombudsman Program for a period not less than 90 school days. Any student in high school committing an act of bullying for the third time during their high school years will be assigned to the Ombudsman Program for a period not less than 90 school days. A parent or guardian may appeal this placement by requesting that a disciplinary tribunal be convened.

Upon a finding by a school administrator that a student has committed an act of bullying or is a victim of bullying, the administrator or designee shall notify the parent, guardian, or other person having control or charge of the student by telephone call or through written notice, which may be done electronically. Students and parents will be notified of the prohibition against bullying and the penalties for violating the prohibition by posting information at each school and by including such information in the student/parent handbooks.

Procedures will be developed at each school encouraging a teacher or other school employee, student, parent, guardian or other person who has control or charge of a student, either anonymously or in the person's name, to report or otherwise provide information on bullying activity. Any teacher or other school employee who, in the exercise of his or her personal judgment and discretion, believes he or she has reliable information that would lead a reasonable person to suspect that someone is a target of bullying is encouraged to immediately report it to the school principal or designee. Any report will be appropriately investigated by the administration based upon the nature of the complaint in a timely manner to determine whether bullying has occurred, whether there are other procedures related to illegal harassment or discrimination that should be implemented and what other steps should be taken. Any report of retaliation for reporting bullying will also be investigated and addressed as called for in this policy and in accordance with school procedures.

RULE 6 - WEAPONS, DANGEROUS INSTRUMENTS, AND EXPLOSIVE/IMPLOSIVE DEVICES

A student shall not solicit to buy or sell, or buy or sell, or possess, handle, transmit, threaten with or discharge/use any object that can reasonably be considered or converted to and/or used as a weapon, such as, but not limited to, the following categories:

Firearms - handgun; rifle or shotgun; BB or pellet gun; starter gun

Dangerous Weapons - destructive device (bomb, grenade, mine, bazookas, recoilless rifles, rocket launchers having a propellant charge of more than four ounces, missile having an explosive or incendiary charge of more than one-quarter ounce, pipe bomb or similar device); toy or any look-alike gun; fireworks or explosives, including live bullets

Hazardous Objects - knife less than 2 inches; brass knuckles or metal knucks; lighters (any type used as a weapon or used to start a fire); tear gas, mace, or pepper spray; bats, clubs, sticks, or other instruments of a bludgeoning type (other than for athletics); Chinese stars; razors or razor blades; spring stick; black jack; nun chahka, nun chuck, nunchaku, shuriken, fighting chain (any flailing instrument consisting of two or more rigid parts connected in such a manner as to allow them to swing freely); throwing star, oriental dart, any disc having two points or pointed blades which is designed to be thrown or propelled; stun gun, laser, or non-lethal air gun as provided for in O.C.G.A. 16-11-127.1.

All school employees are required to report criminal activity to their school principal if they have "reasonable cause." "Reasonable cause" includes knowledge of any person under eighteen (18) carrying weapons at school functions or within school safety zones and illegal possession of a pistol or revolver by a person. The principal is required to report such activity immediately to the superintendent and to the police.

NOTICE: OFFICIAL CODE OF GEORGIA

Possession of a Weapon on School Property or at School Functions – [O.C.G.A 16-11-127.1](#)

Georgia law now provides that possession of a weapon, on school property or at school functions is a felony crime. A student shall be excluded from school for one year (exceptions limited on case-by-case basis) for possessing on school grounds or at a school function a firearm including a starter gun, any weapon which will or is designed to or may readily be converted to expel a projectile by the action of an explosive, the frame or receiver of such a weapon, any firearm muffler or silencer, or any destructive device. See weapon definitions above.

RULE 7 - DRUGS, ALCOHOL, AND TOBACCO

PART A

A student shall not possess, sell, buy, or transmit; or attempt to sell, buy, or transmit any substance under the pretense that it is in fact a prohibited substance as described in this rule. The misuse or unauthorized possession of a prescription drug or nonprescription drug shall be considered a violation of this rule; however, this rule shall not apply to proper possession and/or use of a drug as authorized by a medical prescription from a registered physician. A student shall not be involved in any substance, drug, alcohol, and tobacco transaction, including, without limitation, to buy, possess, sell, use, transmit, or solicit; attempt to buy, possess, sell, use, or transmit; or be under the influence of any narcotic drug, depressant, or stimulant drug including without limitation alcoholic beverage or intoxicant of any kind; amphetamine/methamphetamine drug (ex. crank, speed, uppers, ice, etc.); hallucinogenic drug (ex. peyote, PCP, etc.); anabolic steroid (controlled prescription drug) (ex. steroids, juice, roids, etc.); barbiturate drug (controlled prescription drug) (ex. phenobarbital, amobarbital, metharbital, etc.); marijuana (ex. dope, weed, hay, leaf, etc.; LSD (ex. acid, cube, blue heaven, etc.); cocaine (ex. crack, coke, dust, rock, etc.); Ritalin (controlled stimulant prescription drug); heroin (ex. antifreeze, big daddy, china man, etc.); caffeine pill; inhalant; and/or intoxicant of any kind.

PART B

A student shall not possess, sell, use, transmit, buy, or solicit any drug-related paraphernalia which includes, but is not limited to, pipes, water pipes, clips, rolling papers, and/or herb pills.

PART C

A student shall not possess, sell, use, transmit, buy, or solicit tobacco products or tobacco paraphernalia, such as, but not limited to, cigarettes, dip, snuff, matches, tobacco-related pipes, lighters, and/or tobacco-related rolling papers.

Procedures for Handling Incidents of Abuse

Procedure for handling incidents in the schools involving the possession, sale or conspiracy to sell, and/or use of drugs, alcohol, steroids, or any other behavior-affecting substances shall be as follows:

- A. Definite assignments shall be given to personnel within the individual school.
 1. The principal will be responsible for carrying out the policy and its supporting procedures within his/her school.
 2. The principal will serve as the clearing point for records, reports, and inquiries relating to his/her school.
 3. Staff members will pass concerns to any of the school's administrative staff. Administrative staff members are the principal and assistant principal.
- B. The names of students involved will not be released.
- C. The parents of any involved students shall be contacted immediately.
- D. Disciplinary action shall be specific.
 1. A student known to be in possession of such substances at school shall be suspended from school for a period not to exceed ten (10) days.
 2. A student known to be under the influence of such substances at school shall be suspended from school for a period not to exceed ten (10) days. A physician's written clearance shall precede a return to school, if warranted.
 3. A student known to be distributing such substances at school shall be recommended to the board for disciplinary action.
- E. The school will cooperate with the police department by making every effort to identify and report the source of supply and by developing an in-service instruction program for staff members.
- F. The schools will make every effort to help students who are having a drug problem by utilizing the following resources: drug abuse education, cooperation with the city or county health department and individual physicians in appropriate health education and health care, and other appropriate means.
- G. A copy of this policy shall be provided to all parents and students.
- H. There shall be a biennial review of this program to determine its effectiveness, to implement changes to the program if needed, and to ensure that the disciplinary sanctions imposed by this policy are consistently enforced.

RULE 8 - INDECENCY

A student shall not engage in any act of sexual harassment of a physical nature or verbal nature. A student shall not perform any act of lewd exposure, gesture or lewd caress or indecent fondling/touching of a student's own body or the body of another person, or any act of sexual intercourse. A student shall not use any inappropriate gestures that mimic or imply sexual acts. A student shall not possess, view, copy, sell, buy or transmit printed or non-printed pornographic materials including any noncurricular sexually explicit printed or non-printed materials; or a student shall not possess, view, copy, sell, buy or transmit printed or non-printed pornographic materials, including but not limited to, noncurricular materials depicting the human male or female genitals or buttocks with less than a fully opaque covering or any portion of the female breast with less than a fully opaque covering. This includes, but is not limited to, the following:

- a) sexual harassment (physical, written, or verbal),
- b) lewd exposure (any act of),
- c) obscene gestures or gestures that mimic or imply sexual intercourse,
- d) lewd caress or indecent fondling/touching of the student's own body,
- e) lewd caress or indecent fondling/touching of the body of another person,
- f) sexual intercourse (mutual consent),
- g) oral sex (mutual consent),
- h) sexual battery (forcibly having sex with another person against the person's will or lack of mental maturity) (ex. rape, sodomy, molestation, etc.),
- i) pornographic materials (printed or non-printed),
- j) kissing or any act of intimacy, and/or
- k) inappropriate bodily contact.

RULE 9 - TARDIES AND ABSENT WITHOUT LEAVE FROM CLASS AND SCHOOL

A student shall not be tardy to school or any class or other required school function during required school hours except for illness or other providential cause, except with written permission of the teacher, principal, or other fully authorized school official, nor shall any student encourage, urge, or counsel other students to violate this rule. A student may not leave school grounds or class prior to the end of the school day, after his/her initial arrival on campus, without the permission of a duly authorized school official. This rule applies to, but is not limited to, tardy to class, tardy to school, AWOL from class, AWOL from school, and/or encourage, urge, or counsel another student to violate this rule.

RULE 10 - OTHER CONDUCT WHICH IS SUBVERSIVE TO GOOD ORDER

A student shall not perform any other act which is subversive to good order and discipline in the schools. This includes, but is not limited to, violating local school rules; violating local law, state law, or federal law; violating compulsory attendance; gang-related activity or behavior; hate or hate-group related activity or behavior; provide false information (lying); cheating; paging devices; laser pointers; electronic communications (cellular telephones, radios, televisions, etc.); actions that are ethnically or racially inflammatory; loitering; criminal trespassing; community misconduct that would pose a threat to the school community; altering grades in a teacher's grade book or any other record or misrepresent

information on school records or forms; driving on school grounds without a license; and/or gambling.

The administration of the school system and the local schools reserve the right to punish behavior which is subversive to good order and discipline in the Camden County School System even though such behavior is not specified in the preceding written discipline rules.

ELECTRONIC PAGERS & PHONES POLICY

A student may not use personal electronic devices during the instructional day without teacher or administrator consent for instructional purposes only. A student found in violation of this prohibition shall be subject to disciplinary action. School administration may determine appropriate consequences for violation of this rule.

RULE 11 - SECRET SOCIETIES/GANG ACTIVITY

Gangs which initiate, advocate, or promote activities which threaten the safety or well-being of persons or property on school grounds or which disrupt the school environment are harmful to the educational process. The use of hand signals, graffiti, or the presence of any apparel, jewelry, accessory, or manner of grooming which, by virtue of its color, arrangement, trademark, symbol, or any other attribute indicates or implies membership or affiliation with such a group, presents a clear and present danger. This is contrary to the school environment and educational objectives and creates an atmosphere where unlawful acts or violations of school regulations may occur. Incidents involving initiations, hazings, intimidations, and/or related activities of such group affiliations which are likely to cause bodily danger, physical harm, or personal degradation or disgrace resulting in physical or mental harm to students are prohibited.

SAFE SCHOOLS POLICY

It is the policy of the Camden County Board of Education to ensure the highest possible standards of learning, as well as the safety, health, and well-being of its students and employees. The Camden County Board of Education recognizes that gangs/hate groups and gang/hate group-related activities can substantially interfere with student and employee productivity. In accordance, the Camden County Board of Education is dedicated to preventing the influence of gang/hate groups or gang/hate group-related activities in its schools and will accept a zero tolerance for such activities. The appropriate school officials reserve the right to punish any gang/hate group or person displaying gang/hate group related behavior which is subversive to good order, discipline, and well-being in our schools.

RULE 12 - REPEATED VIOLATIONS/MISBEHAVIOR/CHRONIC DISCIPLINARY PROBLEM STUDENTS

Students who chronically disrupt or repeatedly violate other school rules may be charged with repeated violations of school rules or misbehavior. This rule applies after remediation attempts, including the development and implementation of a student disciplinary and behavioral correction plan.

The student and parent must be notified in advance that further violations will lead to a RULE 12 charge pending a disciplinary tribunal hearing which may result in long-term suspension or expulsion.

Any time a teacher or principal identifies a student as chronic disciplinary problem student, the principal shall notify the student's parent or guardian of the disciplinary problem by certified mail with return receipt requested, first class mail, or by telephone call; the principal or his/her designee shall invite the parent or guardian to observe the student in the classroom situation; and the principal or his/her designee shall request at least one parent to attend a conference with the principal or the teacher or both to devise a disciplinary and behavioral correction plan.

RULE 13 - BUS SAFETY VIOLATIONS

Rules 1 through 12 above apply to behavior on buses also, and discipline will be applied for violation of these rules when on a school bus. A student shall not violate any of the bus safety guidelines listed below. Students:

- a) must stand away from streets where vehicles travel when waiting at the bus stop.
- b) must board the bus one at a time, in an orderly manner, and go directly to their assigned seats. They also must disembark the bus in an orderly manner, in single file.
- c) must refrain from noisy and boisterous conversation or other distracting acts.
- d) must keep their seat area free from litter.
- e) are prohibited from throwing any object onto or off the bus.
- f) must not deface or cause damage to a bus in any way.
- g) must remain seated during the entire trip to and from school.
- h) must not have any part of their bodies outside the bus at any time.
- i) must not open windows without permission from the bus driver.
- j) must stay clear of and must not tamper with the emergency door or any other emergency equipment.
- k) must keep the aisle, the front, and emergency exits free from obstruction at all times. Band instruments will be permitted only when they can be held in the student's lap or placed under the seat of the bus and not obstruct the driver's view or the boarding and unloading of the bus.
- l) are prohibited from bringing glass objects and live animals on the bus.
- m) must remain seated until the bus comes to a complete stop and must not loiter around the bus once they have disembarked.
- n) are prohibited from using any electronic devices during the operation of a school bus, including, but not limited to, cell phones, pagers, audible radio and tape or compact disc players without headphones, or any other electronic device in a manner that might interfere with the school bus communications equipment or the school bus driver's operation of the school bus.
- o) are prohibited from using mirrors, lasers, flash cameras, or any other lights or reflective devices in a manner that might interfere with the school bus driver's operation of the school bus.
- p) will cross the highway, if necessary, after leaving the bus by making certain that the bus is stationary; upon disembarking from the bus, standing at the side of the road and waiting for proper signal to cross; and upon signal from the driver, looking both to the left and to the right, and if the way is clear, proceeding across the highway in front of the bus.

q) must be quiet when the bus is approaching or crossing railroad tracks.

A parent conference must be held with the parent or guardian of any student who is found to have engaged in bullying, physical assault, or battery on a school bus for the purpose of forming a school bus behavior contract for the student. The contract, documented on the Disciplinary and Behavioral Correction Plan form, must provide for progressive age-appropriate discipline, penalties, and restrictions for student misconduct on the school bus.

PART B

Clubs and organizations shall operate within the guidelines of the student behavior code of conduct.

BUS CONDUCT

The school bus is an extension of the classroom. Problems on school buses will be handled in the same manner as other school disciplinary problems. Students will be informed of specific rules, regulations, and consequences. Rules for bus behavior include, but are not limited to, the driver's instructions must be obeyed at all times; fighting is not permitted; weapons are not allowed; appropriate language must be used; possession or use of tobacco, alcohol, and drugs is prohibited; and students must remain seated when the bus is in motion.

When handling inappropriate bus behavior, a school administrator will discuss the behavior with the student, determine consequences of misbehavior, and talk to parents about student's behavior. Penalties for inappropriate behavior will be determined according to the frequency and severity of the violation(s). When behavior is habitual or a major violation, the student may be suspended from the bus for an indefinite period. See Rule 13 in the Student Behavior Code.

BUS PASS PROCEDURE

Students who are to get off the bus at a location other than the regular stop must have a written request from parents indicating the location where the student should get off the bus. This note should be taken to the office and exchanged for a bus pass. Bus drivers will accept only bus passes signed by appropriate school personnel. Students who ride the bus to school must also ride the bus home in the afternoon unless they have prior written permission from their parents or guardians.

SCHOOL BUS SAFETY REMINDER

The rules that govern our buses are designed primarily for the safety of our students. The rules help to minimize distractions and obstructions for the driver and alleviate situations that could be potentially dangerous. The safety of our students is of utmost importance. With this in mind, please remember that the center aisle of the bus and the emergency exits must be kept clear at all times. Large, cumbersome items such as science project boards, large athletic equipment, large band instruments, etc. may not be transported on the bus. Glass containers of any type are also prohibited, as are animals and insects (alive or dead).

Students may bring other items on the bus that fit in their laps and will not obstruct any emergency exits.

Please contact the Transportation Office (729-8374) if you have any questions.

EMERGENCY EVACUATION PROCEDURES

- A. Front Door Evacuation
 1. Evacuate the front seat to the left of the first aisle first; then empty the front seat to the right side of the aisle.
 2. Continue this alternating procedure (emptying left seat then right seat) until the bus is evacuated.
- B. Rear Door Evacuation
 1. Evacuate the last rear seat to the left of the aisle first, then the last rear seat to the right of the aisle.
 2. Continue this alternating procedure (emptying left seat then right seat) until the bus is evacuated.
 3. The first two students evacuated should help all the other students as they step down from the rear door.
- C. Both Front and Rear Door Evacuation
 1. Students in the front-half of the bus should use the emergency Front Door Evacuation Procedure.
 2. Students in the rear-half of the bus should use the emergency Rear Door Evacuation Procedure.

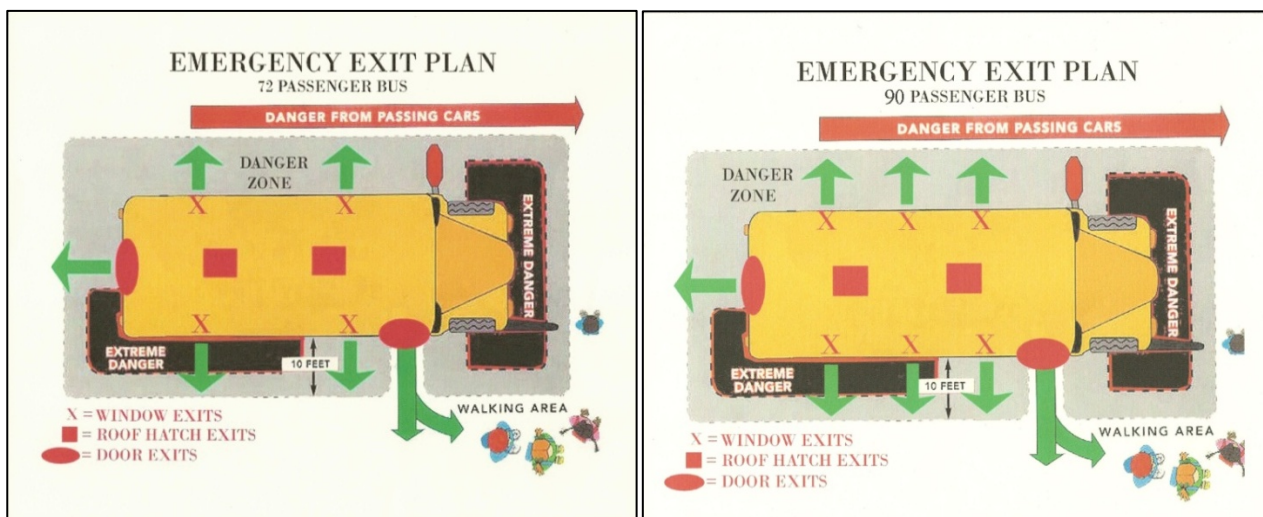

**STUDENT INTERNET – ACCEPTABLE USE AGREEMENT
IMPORTANT NOTE TO PARENTS**

Due to the nature of the Internet, it is neither practical nor possible for Camden County Schools to enforce compliance with user rules at all times. Accordingly, parents and students must recognize that students will be required to make independent decisions and to use good judgment when using the Internet. Therefore, parents must participate in the decision of whether or not to allow their children access to the Internet and must communicate their expectations to their children regarding its use.

As a parent/guardian of this student, I have read the Student Internet and Inappropriate Use Policy and this Internet Access Agreement.

- I understand that Internet access is designed for educational purposes and that the school will attempt to discourage access to objectionable materials and communication that are intended to exploit, harass, or abuse students. However, I recognize that it is impossible for the school district to restrict access to all objectionable material, and I will not hold the district responsible for materials acquired or contacts made on the network.
- I understand that a variety of inappropriate and offensive materials are available over the internet and that it may be possible for my child to access these materials if he/she chooses to behave irresponsibly. I also understand that it is possible for undesirable or ill-intentioned individuals to communicate with my child over the Internet, that there is no practical means for the district to prevent this from happening, and that my child must take responsibility to avoid such communications if they are initiated. While I authorize the staff to monitor any communications to or from my child on the Internet, I recognize that it is not possible for the school to monitor all such communications. The district maintains up to date content filters that meet all requirements of the Children’s Internet Protection Act (CIPA).
- I understand that any conduct that is in conflict with these responsibilities is inappropriate, and such behavior may result in the termination of access and possible disciplinary action.
- I have reviewed Internet access responsibilities with my child. I understand Google Docs for Education is for instructional purposes and students may have individual Google accounts.

Parent/Guardian Name(s): _____
(Please Print)

Parent/Guardian Signature(s): _____ Date: _____

STUDENT AGREEMENT

I accept responsibility to abide by the Camden County Schools’ Internet Acceptable Use Policy/Regulation (IFBG/IFBG-R) and guidelines. I understand that the use of the Internet and access to it is privilege, not a right, and I agree:

- To use the Internet network for appropriate educational purposes and research;
- To use the Internet network only with the permission of designated school staff;
- To be considerate of other users on the network and to use appropriate language for school situations;
- Not to intentionally degrade or disrupt Internet network services or equipment (This includes, but is not limited to, tampering with computer hardware or software, vandalizing data, invoking computer viruses, attempting to gain access to restricted or unauthorized network services, bypass filters, access proxy sites, or violating copyright laws.);
- To immediately report any security problems or breeches of these responsibilities to appropriate school system/school staff;
- To comply with all of the rules and expectations included in this access agreement and NOT to use the Internet inappropriately; and
- Not to divulge personal information, such as addresses and telephone numbers, over the Internet.

I understand that I have no right to privacy when I use the district’s Internet device or network. I also understand that any conduct that is in conflict with these responsibilities is inappropriate and may result in termination of network access and possible disciplinary action. I agree to abide by this agreement.

Student Name: _____ Grade: _____
(Please Print)

Student Signature: _____ Date: _____

STUDENT INTERNET CODE OF ETHICS

1. Students accessing or using web products including, but not limited to, blogs, wikis, podcasts, Google applications, etc., for student assignments are required to keep personal information out of their postings. Students will not post or give out photographs of themselves or others, their family name, password, user name, email address, home address, school name, city, country or other information that could help someone locate or contact them in person.
2. Students will not log in to the network as another classmate.
3. Students using web tools will treat these tools as a classroom space. Speech that is inappropriate for class is not appropriate on web tools. Students are expected to treat others and their ideas on line with respect.
4. Assignments on web tools are like any other assignments in school. Students, in the course of completing the assignment, are expected to abide by policies and procedures in the student handbook, including those policies regarding plagiarism and acceptable use of technology.
5. Student blogs are to be a forum for student expression. However, they are first and foremost a tool for learning. The district may restrict speech for valid educational reasons.
6. Students shall not use the Internet, in connection with teacher assignments, to harass, discriminate, or threaten the safety of others. If students receive a comment on a blog or other web tool used in school that makes them feel uncomfortable or is not respectful, they must report this to a teacher, and must not respond to the comment.
7. Students accessing web tools from home or school using school equipment shall not download or install any software without permission.
8. Students should be honest, fair, and courageous in gathering, interpreting and expressing information for the benefit of others. Always identify sources and test the accuracy of information from all sources.
9. Students will treat information, sources, subjects, colleagues, and information consumers as human beings deserving of respect. Gathering and expressing information should never cause harm or threaten to be harmful to any person or group of people.
10. Students are accountable to their readers, listeners, viewers, and to each other. Students should report unethical information and practices to school staff.
11. Failure to follow this Code of Ethics will result in academic sanctions and/or disciplinary action.

Student Name: _____
(Please Print)

Grade: _____

Student Signature: _____

Date: _____



This handbook is meant to serve as a guide to students, parents, and teachers. It is filled with information such as school rules and policies, discipline, the school calendar, and cafeteria costs.

Please sign the form below and return to your child's teacher by the second Friday of the school year. It will be kept on file.

Child's Name _____

Teacher's Name _____

Grade _____

I have received and read the 2014-2015 Student Handbook and have read it with my child.

Please provide me with paper copies of the following policies referenced in this handbook:

_____	_____
_____	_____
_____	_____

Parent Signature

Date